

# LED Bar Light

HDBB-CH(75×n)S-UV- (ショートタイプ)  
 HDBB-CH(75×n)L-UV- (ロングタイプ)

- \* Only 24V USE
- \* Electric Power Consumption (7.5xn)W

(Note) Please do not remove the tags attached to the product.  
 Light-emitting part during lighting, please do not look directly.

(注) 製品に取り付けられているタグは外さないでください。  
 点灯中の発光部は、直視しないでください。

Slide nut / pcs	lighting length	n	Wave length
2	75	01	365
	150	02	(375)
	225	03	385
3	300	04	(395)
	375	05	(405)
4	450	06	
	525	07	
	600	08	
	675	09	

## Details of Connector

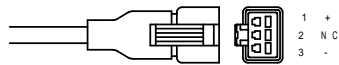

	Light	Power Supply
Connector	SMR-03V-B	SMP-03V-BC
Contact	BYM-001T-P0.6	BHF-001T-0.8SS

## 標準アクセサリ

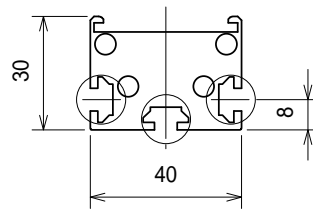
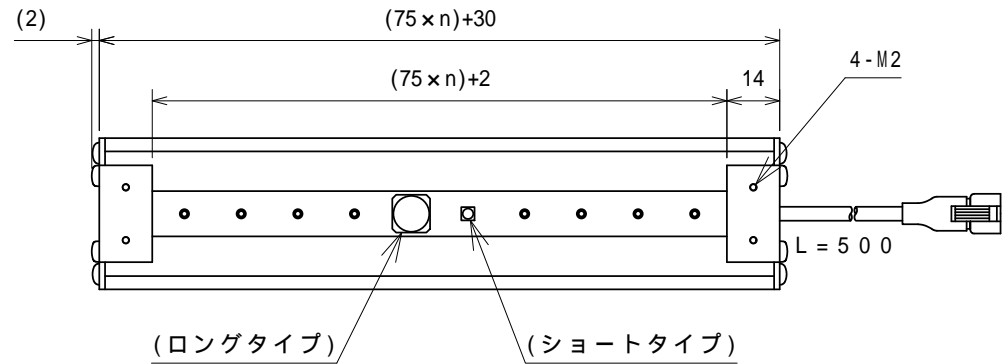
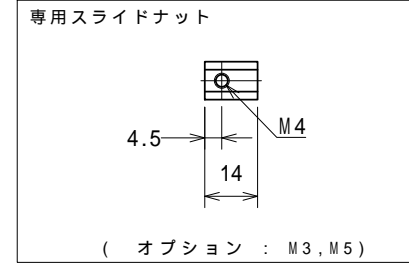

## 詳細

